

# HSF

Recommended P. C. B Layout (Top Side)  
(PCB BOARD TOLERANCE ± 0.05)

**NOTES:**

1. Electrical Performance:
  - 1-1. Current Rating: 0.5 A at AC 100V.
  - 1-2. Withstand Voltage: 250V AC.
  - 1-3. Contact Resistance: See Table.  $\triangle$
  - 1-4. Insulation Resistance: 1000M $\Omega$  Min.
  - 1-5. Operation Temperature: -55°C to +85°C
2. Material:
  - 2-1. Housing: LCP; Black/Natural; UL94V-0.  $\triangle$
  - 2-2. Contact: Phosphor Bronze, T=0.20mm.
  - 2-3. Fitting Nail: Brass, T=0.25mm.
  - 2-4. Metal Cap: Stainless Steel, T=0.20mm.
3. Finish:
  - 3-1. Contact: Gold Plating On Contact Area; Matte Tin Plating On Solder Tails, Over Ni.
  - 3-2. Fitting Nail: Sn Plating Over Ni Under Plating

Flatness: <80 Pins The "M" Is 0.12mm MAX  
 ≥80 Pins The "M" Is 0.15mm MAX

## Ordering Information

3660-PXXX - XXX XX R 01

No. of Pins    Housing High    Contact Plating    R=Tape&Reel+CAP

G1=3u"Gold  
 G2=5u"Gold  
 G2=10u"Gold  
 S1=3u"Gold/Tin  
 S2=5u"Gold/Tin  
 S3=10u"Gold/Tin

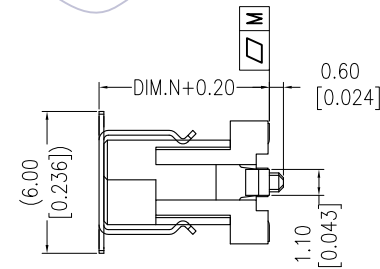
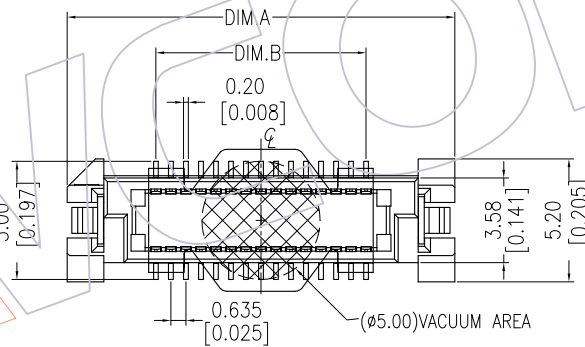
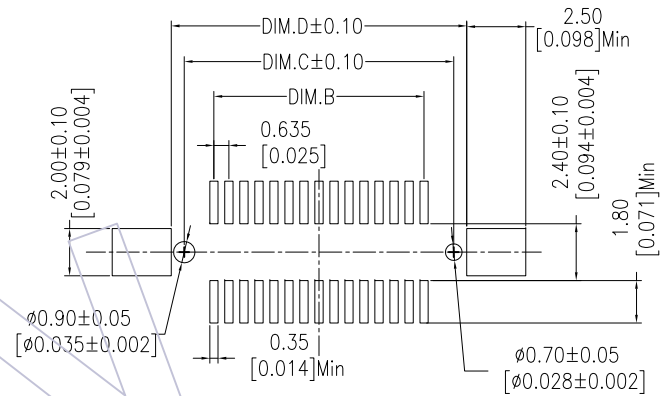
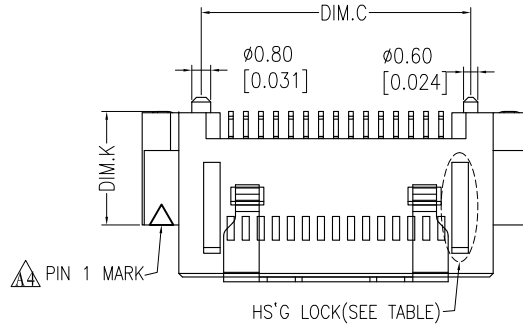

ASS'Y HIGH (H)	Before Test	After Test
6.0 ~ 7.0	≤ 40m $\Omega$	≤ 60m $\Omega$
8.0 ~ 10.0	≤ 50m $\Omega$	≤ 70m $\Omega$
11.0 ~ 13.0	≤ 60m $\Omega$	≤ 80m $\Omega$
14.0 ~ 16.0	≤ 70m $\Omega$	≤ 90m $\Omega$

PART NO.	DIM.N	DIM.K
3660-PXXX-050XXR01	5.00	2.80
3660-PXXX-060XXR01	6.00	3.80
3660-PXXX-070XXR01	7.00	4.80
3660-PXXX-080XXR01	8.00	5.80
3660-PXXX-090XXR01	9.00	6.80

ASS'Y HIGH(H)	PLUG(H1)	SOCKET(H2)
6.00	5.00	4.00
7.00	6.00	
8.00	7.00	
9.00	8.00	
10.00	9.00	10.00
12.00	5.00	
13.00	6.00	
14.00	7.00	
15.00	8.00	
16.00	9.00	

REV	DATE	MODIFICATION DESCRIPTION	CHANGE	OPERATION	DRAW	DATE	SCALE	FIT	PART NO.
A4	2014/05/07	Modify	$\triangle$	OPERATION	DRAW	2014/05/07	UNIT	mm	3660-PXXX-XXXXXR01
A3	2014/03/07	Modify The Contact Resistance	$\triangle$	X.X    ±0.40	Allen		inch	TITLE:	
A2	2014/02/27	Modify The Housing Material	$\triangle$	X.XX    ±0.25	CHECK	DATE	SIZE	A4	0.635mm BTB "M" TYPE MALE 180° SMT $\triangle$
A0	2012/11/20	NEW	—	X.XXX    ±0.15	APPROVE	DATE	SHEET	1/2	
				Angle    ± 3'			PROJ.	$\phi$	Customer NO.
				DIM    TOL					

HSF

3660-PXXX-050XXR01

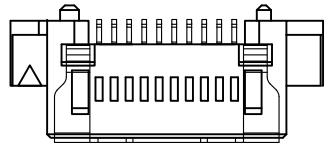

PIN数=20P

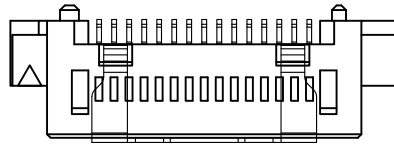

PIN数 ≥ 30P

3660-PXXX-080XXR01

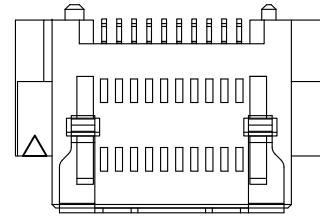

PIN数=20P

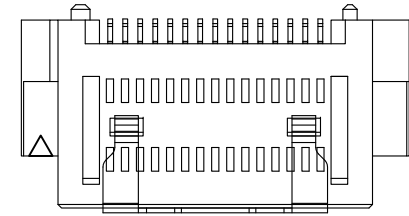

PIN数 ≥ 30P

3660-PXXX-060XXR01

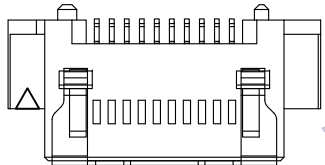

PIN数=20P

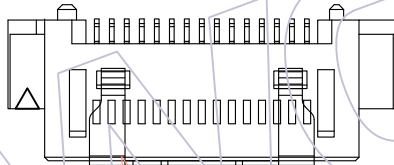

PIN数 ≥ 30P

3660-PXXX-090XXR01

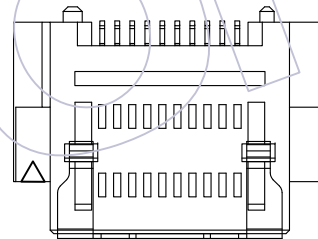

PIN数=20P

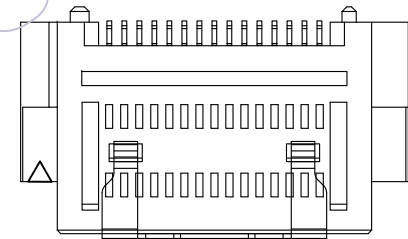

PIN数 ≥ 30P

3660-PXXX-070XXR01

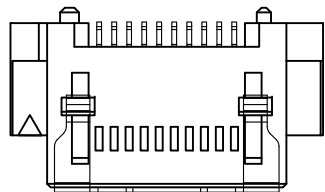

PIN数=20P

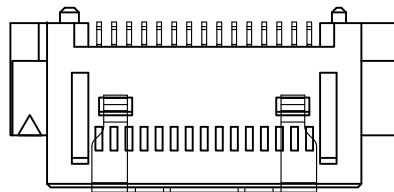

PIN数 ≥ 30P

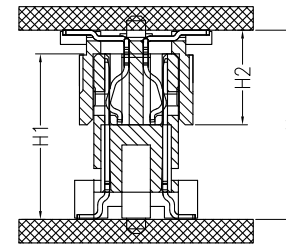

Assembly

NO	53.77	52.67	50.165	57.67	160
	47.42	46.32	43.815	51.32	140
	41.07	39.97	37.465	44.97	120
	34.72	33.62	31.115	38.62	100
	31.55	30.45	27.940	35.45	90
YES	28.37	27.27	24.765	32.27	80
	25.20	24.10	21.590	29.10	70
	22.02	20.92	18.415	25.92	60
	18.85	17.75	15.240	22.75	50
	15.67	14.57	12.065	19.57	40
HS'G LOCK	12.50	11.40	8.890	16.40	30
	9.32	8.22	5.715	13.22	20
	DIM.D	DIM.C	DIM.B	DIM.A	PIN NO

A4	2014/05/07	Modify		OPERATION	DRAW	DATE	SCALE	FIT	PART NO.
A3	2014/03/07	Modify The Contact Resistance		X.X ±0.40	Allen	2014/05/07	UNIT	mm	3660-PXXX-XXXXXR01
A2	2014/02/27	Modify The Housing Material		X.XX ±0.25	CHECK	DATE	inch	A4	TITLE:
A0	2012/11/20	NEW	—	X.XXX ±0.15	APPROVE	DATE	SHEET	2/2	0.635mm BTB "M"TYPE MALE 180° SMT
REV	DATE	MODIFICATION DESCRIPTION	CHANGE	Angle ± 3'			PROJ.		Customer NO.
				DIM TOL					